

ATTACHMENT B – Base Description & Pole

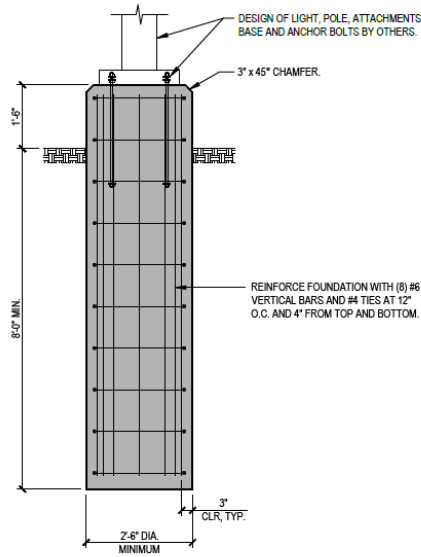

1
**LIGHT POLE FOUNDATION
DETAIL**
 SKS01 NO SCALE

GENERAL STRUCTURAL NOTES:

A. CODES AND SPECIFICATIONS

1. 2013 KENTUCKY BUILDING CODE.
2. ASCE 7-10, MINIMUM DESIGN LOADS FOR BUILDINGS AND OTHER STRUCTURES.
3. ACI 301-10, SPECIFICATIONS FOR STRUCTURAL CONCRETE FOR BUILDINGS AS MODIFIED BY THE CONSTRUCTION DOCUMENTS.
4. ANSINAAMM FP 1001-07, GUIDE SPECIFICATIONS FOR DESIGN OF METAL FLAGPOLES.

B. FOUNDATIONS

1. THE FOUNDATION DESIGN IS BASED UPON THE RECOMMENDATIONS INCLUDED IN CHAPTER 18 OF THE INTERNATIONAL BUILDING CODE.
2. FOOTINGS ARE DESIGNED FOR A MAXIMUM VERTICAL FOUNDATION PRESSURE OF 1500 PSF AND A MAXIMUM LATERAL BEARING PRESSURE OF 100 PSF PER FOOT BELOW NATURAL GRADE ON NATURAL SOILS CONSISTING OF CLAY, SANDY CLAY, AND SILTY CLAY PER INTERNATIONAL BUILDING CODE TABLE 1806.2.
3. NOTIFY THE ENGINEER IF SOILS DISCOVERED DURING CONSTRUCTION DO NOT MATCH THE SOILS LISTED ABOVE.

C. CONCRETE

1. CONCRETE STRENGTHS:
 - a. FOOTINGS: 3000 PSL.

D. REINFORCING STEEL

1. ALL REINFORCING BARS: 60 KSI YIELD.
2. PROVIDE MINIMUM CLEARANCES BETWEEN REINFORCING STEEL AND CONCRETE SURFACES AS SHOWN. IF NOT SHOWN, PROVIDE CLEAR COVER PER ACI. PLACE ALL REINFORCING AS SHOWN AND DETAILED, AND WITHIN ACI TOLERANCE.

E. DESIGN LOADS

1. WIND LOAD:
 - e. BASIC WIND SPEED (3-SECOND GUST): V = 90 MPH
 - f. EFFECTIVE PROJECTED AREA OF POLE: 25 SQ FT
 - g. TOTAL HEIGHT OF POLE AND LIGHT ABOVE GRADE: 30 FT

G. COORDINATION

1. DESIGN OF LIGHT FIXTURE, POLE, ATTACHMENTS, BASE AND ANCHOR BOLTS BY OTHERS.

PROJECT: NORTHERN KENTUCKY UNIVERSITY LIGHT POLES TITLE: LIGHT POLE FOUNDATION DRAWN: PERMIT AND CONSTRUCTION BY: E.M.F. ALER	DRAWING NUMBER: <div style="text-align: center; font-size: 1.5em; font-weight: bold;">SKS 01</div> DATE: 10/28/2016
----------------------------------------------------------------------------------------------------------------------------------------	----------------------------------------------------------------------------------------------------------------------------

TFP Engineers, Inc.
 200 East English Street
 Chattanooga, TN 37402
 Phone: 423.261.2272
 Fax: 423.261.2881
 www.tfpengineers.com

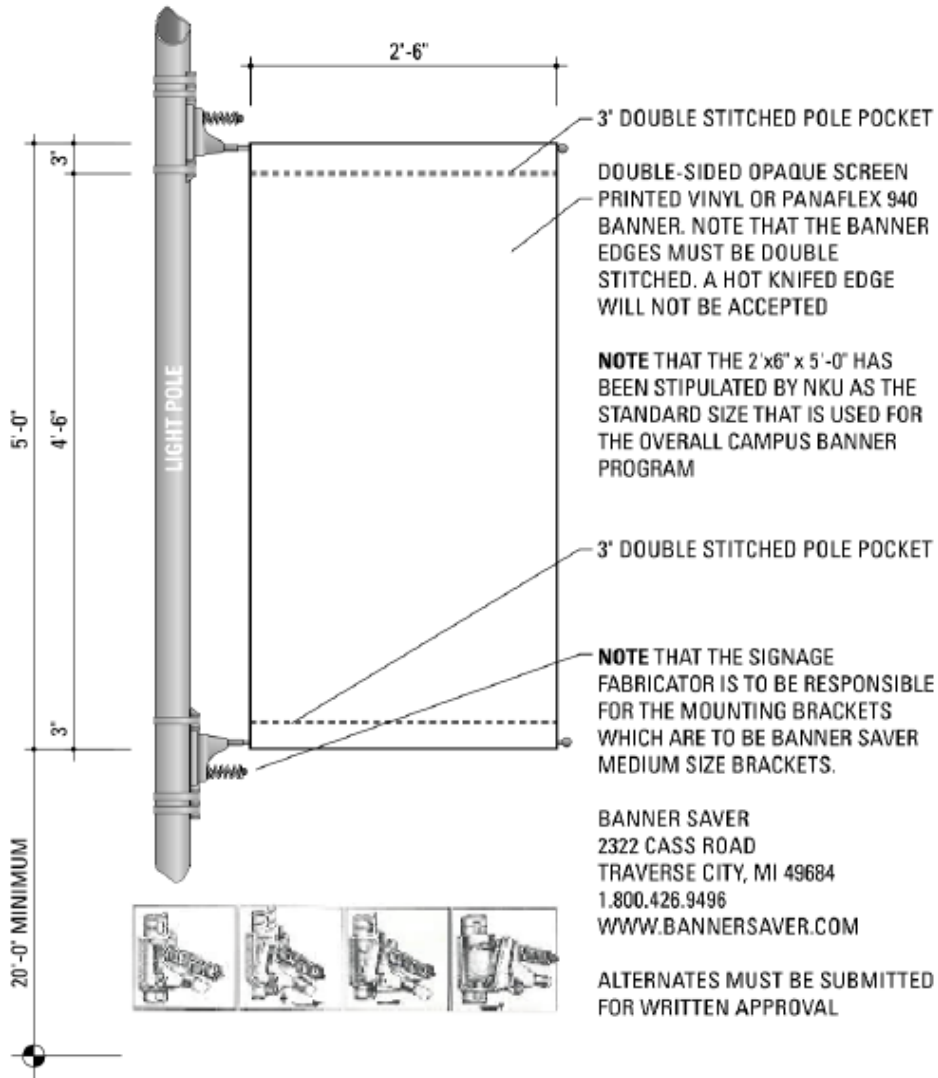

A TYPICAL CAMPUS BANNERS- SIGN TYPE- BAN
7.1 SCALE= 3/4" = 1'-0"